



48 High Street, Pontypool, NP4 7AE

Asking price £280,000



3



1



2



D

48 High Street Pontypool, NP4 7AE



Welcome to this charming detached house located on High Street in Abersychan, Pontypool. This property boasts two reception rooms, providing ample space for entertaining guests or simply relaxing with your loved ones. With three cosy bedrooms, there is plenty of room for the whole family to unwind and rest comfortably.

Don't miss out on the opportunity to own this lovely detached house in Abersychan. Book a viewing today and envision the endless possibilities this property has to offer!

- DETACHED FAMILY HOME
- ENTRANCE/RECEPTION ROOM
- UTILITY ROOM
- KITCHEN/BREAKFAST ROOM
- SPACIOUS LOUNGE/DINER
- THREE BEDROOMS
- WET ROOM
- ENCLOSED REAR GARDEN





Ground Floor

Approx. 73.7 sq. metres (793.1 sq. feet)

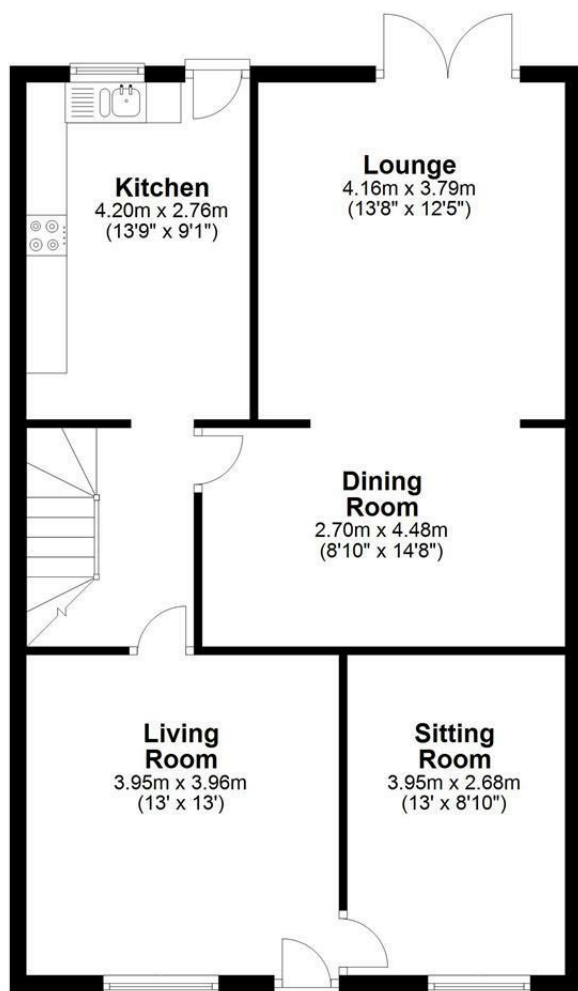

First Floor

Approx. 48.2 sq. metres (518.5 sq. feet)



Total area: approx. 121.9 sq. metres (1311.6 sq. feet)

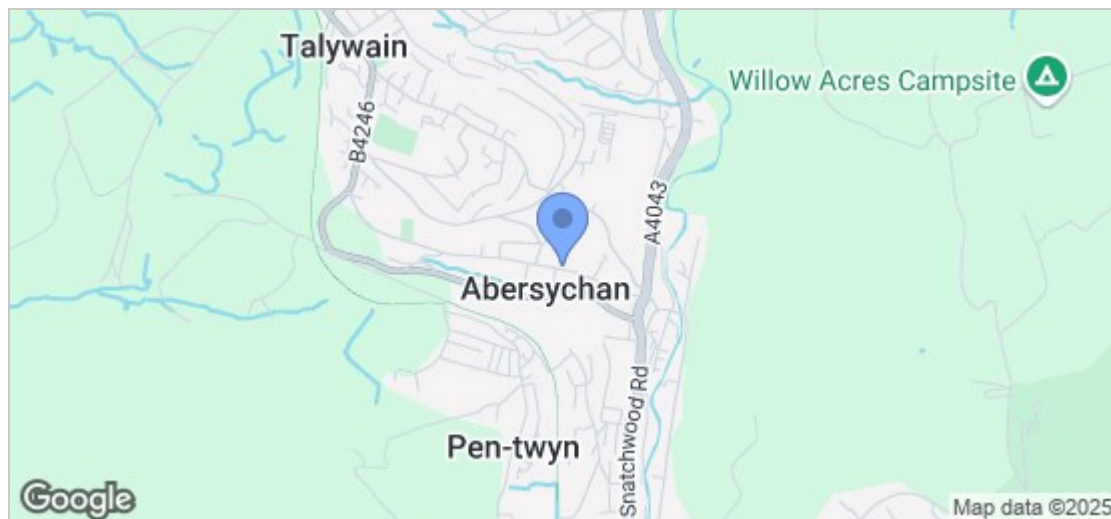

Viewing

Please contact our One2One Estate Agents Torfaen Office on 01495219699 if you wish to arrange a viewing appointment for this property or require further information.

These particulars, whilst believed to be accurate are set out as a general outline only for guidance and do not constitute any part of an offer or contract. Intending purchasers should not rely on them as statements of representation of fact, but must satisfy themselves by inspection or otherwise as to their accuracy. No person in this firm's employment has the authority to make or give any representation or warranty in respect of the property.

Energy Efficiency Rating		
	Current	Potential
Very energy efficient - lower running costs		
(92 plus) A		
(81-91) B		
(69-80) C		
(55-68) D		
(39-54) E		
(21-38) F		
(1-20) G		
Not energy efficient - higher running costs		
England & Wales EU Directive 2002/91/EC		
Environmental Impact (CO ₂) Rating		
	Current	Potential
Very environmentally friendly - lower CO ₂ emissions		
(92 plus) A		
(81-91) B		
(69-80) C		
(55-68) D		
(39-54) E		
(21-38) F		
(1-20) G		
Not environmentally friendly - higher CO ₂ emissions		
England & Wales EU Directive 2002/91/EC		